

Bearing No. 54305

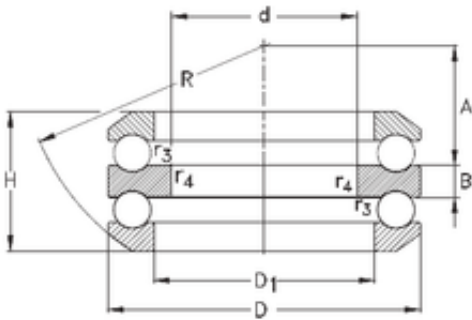

Size	20x52x37.6 mm
Bore Diameter	20 mm
Outer Diameter	52 mm
Width	37,6 mm
d	20 mm
D	52 mm
H	37,6 mm
r1 min.	1 mm
r2 min.	1 mm
r3 min.	0,3 mm
r4 min.	0,3 mm
A	18 mm
B	8 mm
D1	27 mm
R	45 mm
Weight	0,32 Kg
Basic dynamic load rating (C)	34,5 kN
Basic static load rating (C0)	55 kN